

# 90° Special Radius Elbow, Electrical Metallic Tubing (EMT)



Submittal Sheet - Representative Materials Company

## Overview

RMC's EMT Special Radius Elbow is specifically designed to allow changes in direction in the EMT conduit system. It is used when the conduit needs to make a turn, creating a bend in the conduit path. The elbow fitting typically has two openings that allow the EMT conduit to enter and exit at different angles. RMC's EMT elbows are manufactured from our high quality EMT conduit in accordance with the latest specifications and standards of ANSI C80.3 (UL797). Fabricated from galvanized steel for low conductivity and high corrosion resistance, all surfaces, both interior and exterior are free from defect with a smooth welded seam.

## Consistent Quality

- Made from high grade mild strip steel for durability and sustainability.
- Uniform galvanized protection.
- Manufactured for long life - durable and strong.
- No flaking or chipping when subjected to extreme stress.
- Easy to produce wrinkle-free bends, reduced kinking, and minimized splitting from multiple bends.

## Lower Life-Cycle Costs

- Galvanized coating provides enhanced corrosion protection.
- Resists cracking, flaking, peeling, impact, and damage from severe bending.
- Physical and mechanical properties ensure that the pipe has an extended life cycle.
- 100% Recyclable.

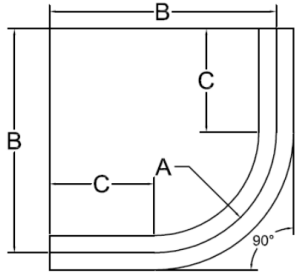

## Interior Coatings

- Interior Coating provides a smooth surface for faster wire pulling.
- Protective coating is placed over galvanizing to provide longer life cycle.
- More wire capacity and less friction between wall to wire to minimize wire chafing.

## Listings

- Underwriters Laboratories Standard for EMT-Steel (UL797) file # E531582
- American National Standards Institute (ANSI® C80.3)
- National Electric Code® Article 358

### Dimension and Weight Chart (EMT) and Packing Schedule (EMT)

90° ELECTRIC METALLIC TUBING (EMT) SPECIAL RADIUS ELBOWS								
ITEM #	UPC	SIZE	MIN. UL RADIUS "A"	OFFSET "B"	STRAIGHT LENGTH "C"	WEIGHT/100PCS	PCS/CARTON	WEIGHT/CARTON
			in.	in.	in.	lbs.		lbs.
EMTSW109018	00810138703663	1" X 90° X 18"	18	28	11	2784	-	1,392
EMTSW129018	00810138703670	1-1/4" X 90° X 18"	18	28	11	2919	-	1,460
EMTSW159018	00810138703687	1-1/2" X 90° X 18"	18	28	11	3027	-	1,513
EMTSW209018	00810138700853	2" X 90° X 18"	18	28	11	765	70	536
EMTSW109024	00810138704103	1" X 90° X 24"	24	35	11	339	-	-
EMTSW129024	00810138704110	1-1/4" X 90° X 24"	24	35	11	511	-	-
EMTSW159024	00810138700778	1-1/2" X 90° X 24"	24	35	11	599	70	419
EMTSW209024	00810138700860	2" X 90° X 24"	24	35	11	765	70	536
EMTSW259024	00810138700921	2-1/2" X 90° X 24"	24	35	11	1073	70	751
EMTSW309024	00810138700983	3" X 90° X 24"	24	35	11	1307	48	627
EMTSW359024	00810138703694	3-1/2" X 90° X 24"	24	35	11	1735	40	694
EMTSW409024	00810138701041	4" X 90° X 24"	24	35	11	1954	40	782
EMTSW109036	00810138704127	1" X 90° X 36"	36	47	11	452	-	316
EMTSW129036	00810138700716	1-1/4" X 90° X 36"	36	47	11	682	70	477
EMTSW159036	00810138700785	1-1/2" X 90° X 36"	36	47	11	783	70	548
EMTSW209036	00810138700877	2" X 90° X 36"	36	47	11	999	70	699
EMTSW259036	00810138700938	2-1/2" X 90° X 36"	36	47	11	1411	70	988

Sizes 2-1/2" and larger shipped in palletized cartons or bulk. Radius A is the minimum per UL797. Dimensions B and C are reference dimensions. All dimensions are approximate. All special radius elbows are noncancelable and nonreturnable.

# 90° Special Radius Elbow, Electrical Metallic Tubing (EMT)



Submittal Sheet - Representative Materials Company

## Dimension and Weight Chart (EMT) and Packing Schedule (EMT)

### 90° ELECTRIC METALLIC TUBING (EMT) SPECIAL RADIUS ELBOWS

ITEM #	UPC	SIZE	MIN. UL RADIUS "A"	OFFSET "B"	STRAIGHT LENGTH "C"	WEIGHT/100PCS	PCS/CARTON	WEIGHT/CARTON
			in.	in.	in.	lbs.		lbs.
EMTSW309036	00810138700990	3" X 90° X 36"	36	47	11	1719	48	825
EMTSW359036	00810138703700	3-1/2" X 90° X 36"	36	47	11	2282	40	913
EMTSW409036	00810138701058	4" X 90° X 36"	36	47	11	2570	40	1,028
EMTSW109048	00810138704134	1" X 90° X 48"	48	60	11	650	-	-
EMTSW129048	00810138704141	1-1/4" X 90° X 48"	48	60	11	700	-	-
EMTSW159048	00810138700792	1-1/2" X 90° X 48"	48	60	11	967	70	677
EMTSW209048	00810138700884	2" X 90° X 48"	48	60	11	1233	70	863
EMTSW259048	00810138700945	2-1/2" X 90° X 48"	48	60	11	1786	70	1,250
EMTSW309048	00810138701003	3" X 90° X 48"	48	60	11	2176	48	1,044
EMTSW359048	00810138703717	3-1/2" X 90° X 48"	48	60	11	2888	40	1,155
EMTSW409048	00810138701065	4" X 90° X 48"	48	60	11	3253	40	1,301
EMTSW109060	00810138704158	1" X 90° X 60"	60	72	11	670	-	-
EMTSW129060	00810138704165	1-1/4" X 90° X 60"	60	72	11	1010	-	-
EMTSW159060	00810138703946	1-1/2" X 90° X 60"	60	72	11	1160	70	812
EMTSW209060	00810138703953	2" X 90° X 60"	60	72	11	1480	70	1,036
EMTSW259060	00810138703960	2-1/2" X 90° X 60"	60	72	11	2160	70	1,512
EMTSW309060	00810138703977	3" X 90° X 60"	60	72	11	2650	48	1,272
EMTSW359060	00810138703984	3-1/2" X 90° X 60"	60	72	11	3480	40	1,392
EMTSW409060	00810138703991	4" X 90° X 60"	60	72	11	3920	40	1,568

Sizes 2-1/2" and larger shipped in palletized cartons or bulk. Radius A is the minimum per UL797. Dimensions B and C are reference dimensions. All dimensions are approximate. All special radius elbows are noncancelable and nonreturnable.

## Submittal Information

Company Name	Phone	Date
Address	Project Name	Project Date
City	Project City	Comments
State & Zip	Project State	