

90° Elbow, Electrical Metallic Tubing (EMT)



Submittal Sheet - Representative Materials Company

Overview

RMC's EMT elbow is specifically designed to allow changes in direction in the EMT conduit system. It is used when the conduit needs to make a turn, creating a bend in the conduit path. The elbow fitting typically has two openings that allow the EMT conduit to enter and exit at different angles. RMC's EMT elbows are manufactured from our high quality EMT conduit in accordance with the latest specifications and standards of ANSI C80.3 (UL797). Fabricated from galvanized steel for low conductivity and high corrosion resistance, all surfaces, both interior and exterior are free from defect with a smooth welded seam.

Consistent Quality

- Made from high grade mild strip steel for durability and sustainability.
- Uniform galvanized protection.
- Manufactured for long life - durable and strong.
- No flaking or chipping when subjected to extreme stress.
- Easy to produce wrinkle-free bends, reduced kinking, and minimized splitting from multiple bends.

Lower Life-Cycle Costs

- Uniform galvanized coating provides enhanced protection.
- Resists cracking, flaking, peeling, impact, and damage from severe bending.
- Physical and mechanical properties ensure that the pipe has an extended life cycle.
- 100% Recyclable.

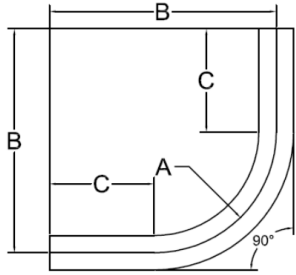

Interior Coatings

- Interior Coating provides a smooth surface for faster wire pulling.
- Protective coating is placed over galvanizing to provide longer life cycle.
- More wire capacity and less friction between wall to wire to minimize wire chafing.

Listings

- Underwriters Laboratories Standard for EMT-Steel (UL797) file # E531582
- American National Standards Institute (ANSI® C80.3)
- National Electric Code® Article 358

Dimension and Weight Chart (EMT) and Packing Schedule (EMT)

90° ELECTRIC METALLIC TUBING (EMT) STANDARD RADIUS ELBOWS

| ITEM # | UPC | SIZE | MIN. UL RADIUS "A" | OFFSET "B" | STRAIGHT LENGTH "C" | WEIGHT/100PCS | PCS/CARTON | WEIGHT/CARTON |
|-----------|----------------|--------|--------------------|------------|---------------------|---------------|------------|---------------|
| | | | in. | in. | in. | lbs. | | lbs. |
| EMTEL0590 | 00810138700051 | 1/2" | 4 | 5.69 | 1.67 | 24 | 50 | 12 |
| EMTEL0790 | 00810138700112 | 3/4" | 4.5 | 6.65 | 2.16 | 43 | 50 | 22 |
| EMTEL1090 | 00810138700174 | 1" | 5.75 | 8.11 | 2.36 | 77 | 20 | 15 |
| EMTEL1290 | 00810138700235 | 1-1/4" | 7.25 | 10 | 2.76 | 142 | 20 | 28 |
| EMTEL1590 | 00810138700297 | 1-1/2" | 8.25 | 11.41 | 3.15 | 187 | 10 | 19 |
| EMTEL2090 | 00810138700358 | 2" | 9.5 | 13.74 | 4.25 | 288 | 10 | 29 |
| EMTEL2590 | 00810138700419 | 2-1/2" | 11 | 15.75 | 5.24 | 467 | 50 | 234 |
| EMTEL3090 | 00810138700471 | 3" | 13 | 18.86 | 5.87 | 685 | 35 | 240 |
| EMTEL3590 | 00810138700532 | 3-1/2" | 15 | 21.73 | 6.73 | 1039 | 35 | 364 |
| EMTEL4090 | 00810138700594 | 4" | 16 | 23.11 | 7.13 | 1285 | 25 | 321 |

Sizes 2-1/2" and larger shipped in palletized cartons or bulk. Radius A is the minimum per UL797. Dimensions B and C are reference.

Submittal Information

| | | |
|--------------|---------------|--------------|
| Company Name | Phone | Date |
| Address | Project Name | Project Date |
| City | Project City | Comments |
| State & Zip | Project State | |