

# 90° Elbow, Galvanized Rigid Conduit (GRC)



Submittal Sheet - Representative Materials Company

## Overview

Rigid conduit elbows are specifically designed to provide a smooth and gradual change in direction for the conduit. They come in various angles, such as 90 degrees (right angle), 45 degrees, and other custom angles, allowing electricians to navigate around obstacles, make turns, stub-ups or bring conduit runs to different heights. Rigid Steel Conduit Elbow is manufactured from prime conduit shell with high-strength in accordance with the latest specifications and standard of ANSI C80.1(UL6). The interior and exterior surface of elbows are free from defect with a smooth welded seam, and are thoroughly and evenly coated with zinc using hot dip galvanizing process.

## Consistent Quality

- Made from high-quality flat rolled steel utilizing high production tube mills utilizing the electric resistance welding method.
- Uniform galvanized protection and smoothness on the interior and exterior coatings.
- The inside surface is obstruction free and smooth to reduce friction between conduit wall and wire.
- Manufactured for long life – durable and strong.
- Threads are galvanized after cutting.
- No flaking or chipping when subjected to extreme stress.

## Listings

- Underwriters Laboratories Standard for rigid conduit (UL6) file # E531580
- American National Standards Institute (ANSI® C80.1)
- National Electric Code® Article 344
- Additional information can be found in the Underwriters Laboratories Inc., General information for Electrical Equipment Directory. The UL product category for Rigid is DYIX.

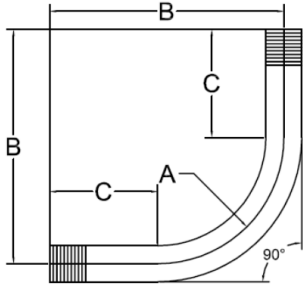

## Locations

- RMC's rigid conduit meets the requirements of National Electrical Code Article 344 for use in indoor and outdoor locations and in wet and dry locations, including Class 1 Division 1 Hazardous Locations.
- Rigid conduit provides exceptional physical protection, reduces exposure to EMF and shields against electromagnetic interference.

## Lower Life-Cycle Costs

- Hot dipped galvanized coating provides enhanced corrosion protection
- Physical and mechanical properties ensure that the pipe has an extended life cycle.
- Resists cracking, flaking, peeling, impact, and damage from severe bending.
- Impact-resistant and non-combustible.
- 100% Recyclable.

### Dimension and Weight Chart and Packing Schedule (GRC)

90° RIGID CONDUIT (GRC) STANDARD RADIUS ELBOWS								
ITEM #	UPC	SIZE	MIN. UL RADIUS "A"	OFFSET "B"	STRAIGHT LENGTH "C"	WEIGHT/100PCS	PCS/CARTON	WEIGHT/CARTON
			in.	in.	in.	lbs.		lbs.
RMCEL0590	00810138702321	1/2"	4	5.69	1.67	66	50	33
RMCEL0790	00810138702376	3/4"	4.5	6.65	2.16	104	50	52
RMCEL1090	00810138702420	1"	5.75	8.11	2.36	185	20	37
RMCEL1290	00810138702475	1-1/4"	7.25	10	2.76	307	20	61
RMCEL1590	00810138702529	1-1/2"	8.25	11.41	3.15	422	10	42
RMCEL2090	00810138702574	2"	9.5	13.74	3.54	683	10	68
RMCEL2590	00810138702628	2-1/2"	11	15.75	4.72	1212	50	606
RMCEL3090	00810138702673	3"	13	18.86	5.32	1884	35	659
RMCEL3590	00810138702727	3-1/2"	15	21.73	6.1	2624	35	919
RMCEL4090	00810138702772	4"	16	23.11	6.5	3372	25	843
RMCEL5090	00810138702826	5"	24	35.16	11.16	6997	BULK	1,749
RMCEL6090	00810138702871	6"	30	43.27	13.26	11286	BULK	2,822

Sizes 2-1/2" and larger shipped in palletized cartons or bulk, with thread protectors on each end. Radius A is the minimum per UL6. Dimensions B and C are reference dimensions.

## Submittal Information

Company Name	Phone	Date
Address	Project Name	Project Date
City	Project City	Comments
State & Zip	Project State	

